

P862CS813JN-GB3-

Price

Lead time

Configuration

Type:	P
Size:	862C
Input:	132 B5 ø300
Output shaft/bore:	ø60
Mounting:	S8
Mounting position:	B3
Input bore:	-
Coupling:	-

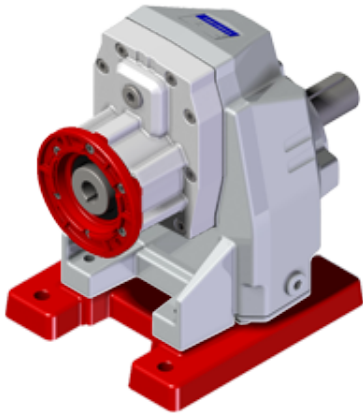

Technical data

Input rpm (n_1):	950 min⁻¹
Output rpm (n_2):	36.71 min⁻¹
Ratio (i):	25.88 (13)
Nominal power (P_{1R}):	9.44 kW
Nominal torque (M_{2R}):	1600 Nm
Dynamic efficiency (RD):	96%

Selection

Motor power (P_{1M}):	4.0 kW
Output torque (M_{2M}):	999 Nm
Service factor (f.s.):	1.6

Direction of rotation

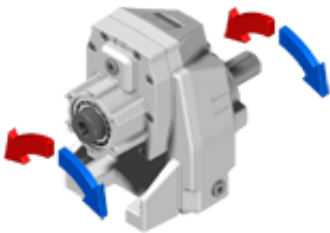

Lubrication

Oil quantity:	Ask
---------------	------------

On our website

Features	Atex certification
How to order	Installation check list
Dimension	Spare parts list
Accessories/options	Complete catalogue
Electric motors	Selection by power (xls)
Selection guide - fs	
Mounting pos. - lubricant	
Calc. the overhung load	

Axial and radial loads

Note

